

**Client**

TEL \_\_\_\_\_

FAX \_\_\_\_\_

Address \_\_\_\_\_

O.REF: \_\_\_\_\_

U.REF: \_\_\_\_\_

Enquiry     Order

# pieces \_\_\_\_\_

Required delivery time \_\_\_\_\_

**Fabrication**    Standard slipping     Custom made to measure

**Number of rings** \_\_\_\_\_

**A** Ring width: \_\_\_\_\_ mm

**B** Ø rings: \_\_\_\_\_ mm

**C** Ø bore: \_\_\_\_\_ mm

**D** Width betw. rings: \_\_\_\_\_ mm

**E** Extension rear: \_\_\_\_\_ mm

**F** Extension front: \_\_\_\_\_ mm

**G** Position connections: \_\_\_\_\_ mm

**H** Ø connections: \_\_\_\_\_ mm

**I** Length over rings: \_\_\_\_\_ mm

**J** Length connections: \_\_\_\_\_ mm

**Connections**

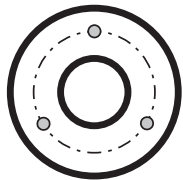

Round connections  
 with thread **M** \_\_\_\_\_

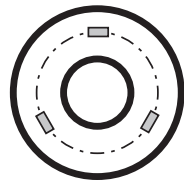

Rectangular connections  
 **L X B** \_\_\_\_\_

**Ring material**

**Connection material**

Re-use of rings  
 Re-use of steel part

**Key-way**

**R** Width \_\_\_\_\_  
**S** Depth \_\_\_\_\_

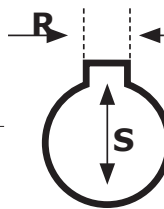

**Ventilation holes**



Machine \_\_\_\_\_  
Capacity \_\_\_\_\_ kW  
Tension \_\_\_\_\_ V  
Speed \_\_\_\_\_ RPM

Electrical verification \_\_\_\_\_  
Insulation test between rings \_\_\_\_\_ V  
Ground insulation test \_\_\_\_\_ V

**COLTEC**  
NERINGSTRAAT 3  
B-3300 BOST  
BELGIUM

TEL    ++ 32 (0) 16 40 23 31  
FAX    ++ 32 (0) 16 40 89 07  
MOBILE ++ 32 (0) 477 24 24 27  
E-mail info@coltec.be